

# ASSEMBLY INSTRUCTIONS



## Office Boffins

A-1 PC



B-1 PC



C-5 PCS



D-6 PCS  
M6×30 mm

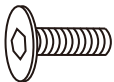

E-6 PCS  
M6×14×1 mm



F-4 PCS  
M6×25 mm



G-4 PCS  
M6×18×1 mm



H-7 PCS  
M8 mm



I-3 PCS  
M8×25 mm



J-3 PCS  
M8×22×1.5 mm



K-1 PC

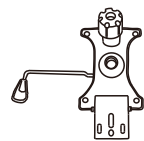

L-1 PC



# HOTM001

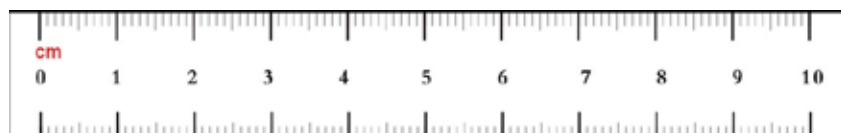

**Do not tighten bolts fully until you have completed assembly.  
DO NOT USE A POWER DRILL TO TIGHTEN THE SCREWS.  
TIGHTEN BY HAND WITH THE ALLEN KEY PROVIDED.**

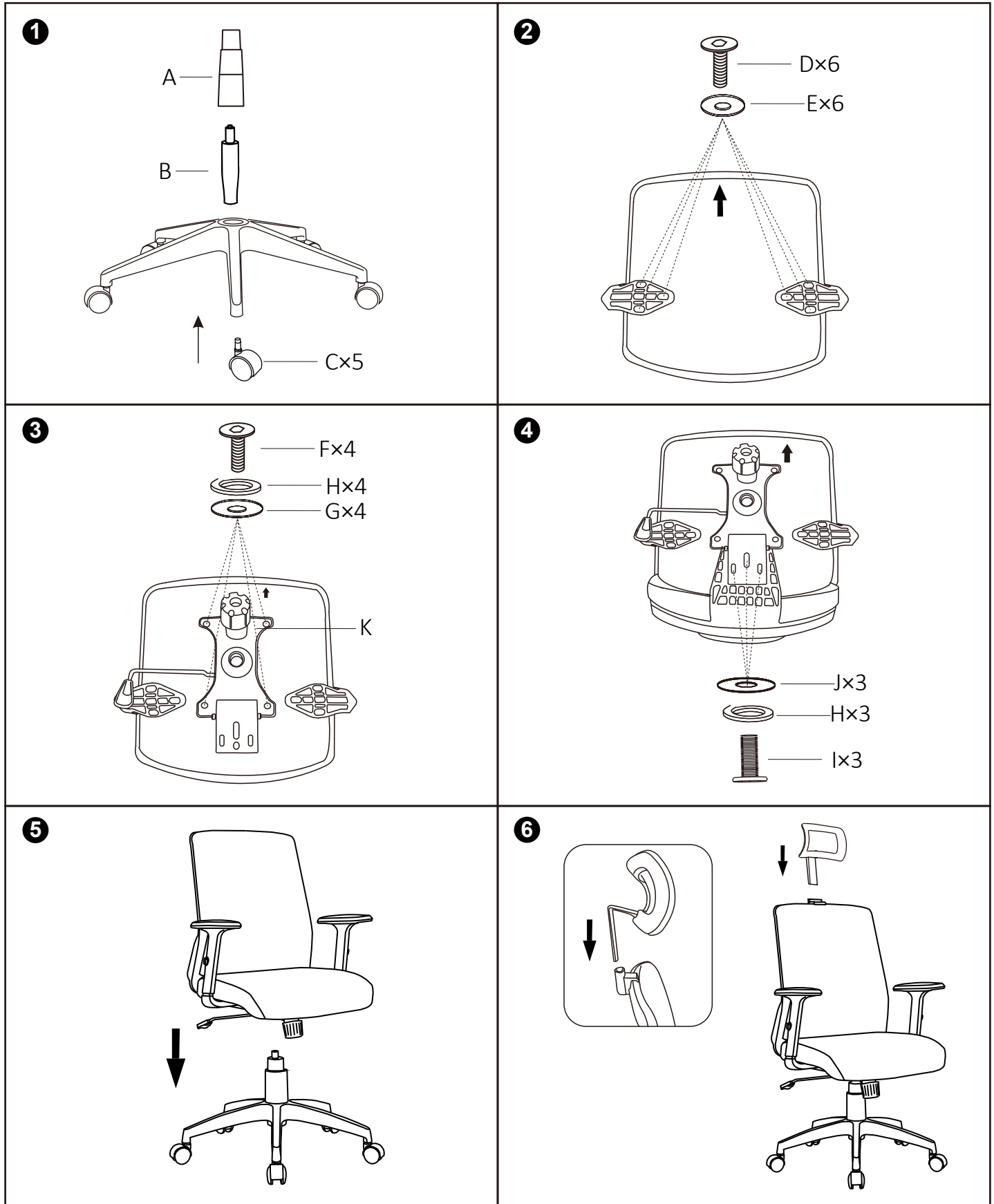

## WARNING

- DO NOT STAND ON THIS CHAIR.
- DO NOT USE THIS CHAIR AS A STEP LADDER.
- USE THIS PRODUCT FOR SEATING ONE PERSON AT A TIME ONLY.
- DO NOT USE THIS CHAIR UNLESS ALL BOLTS, SCREWS AND KNOBS ARE FIRMLY SECURED.
- AT LEAST EVERY 6 MONTHS, CHECK ALL BOLTS, SCREWS AND KNOBS TO BE SURE THEY ARE TIGHT.
- IF PARTS ARE MISSING, BROKEN, DAMAGED OR WORN, STOP USING THIS PRODUCT UNTIL REPAIRS ARE MADE USING FACTORY AUTHORISED PARTS.
- FAILURE TO FOLLOW THESE WARNINGS COULD RESULT IN SERIOUS INJURY.

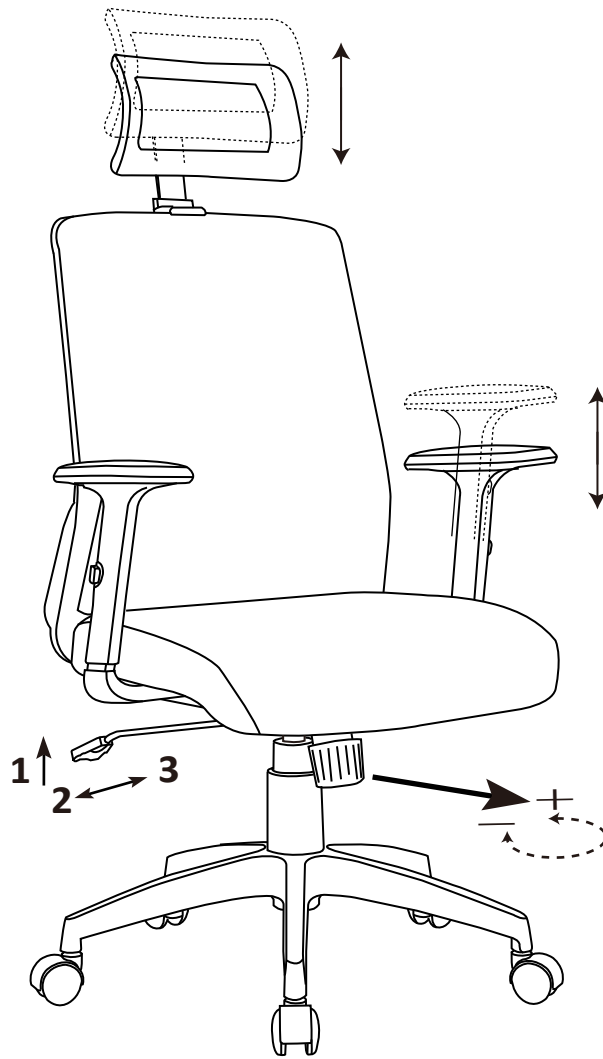

**1**

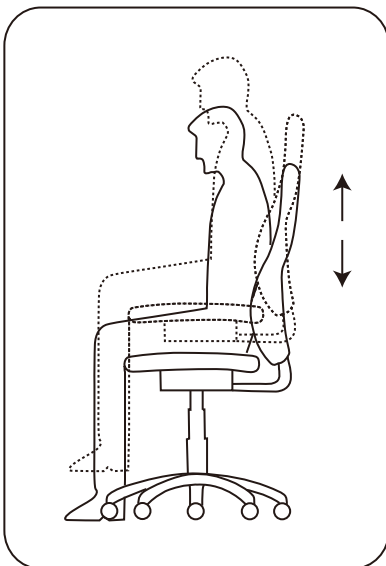

**2**

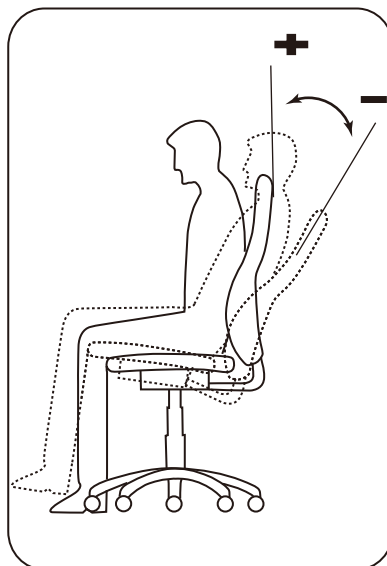

**3**

